

Mariah Stoner

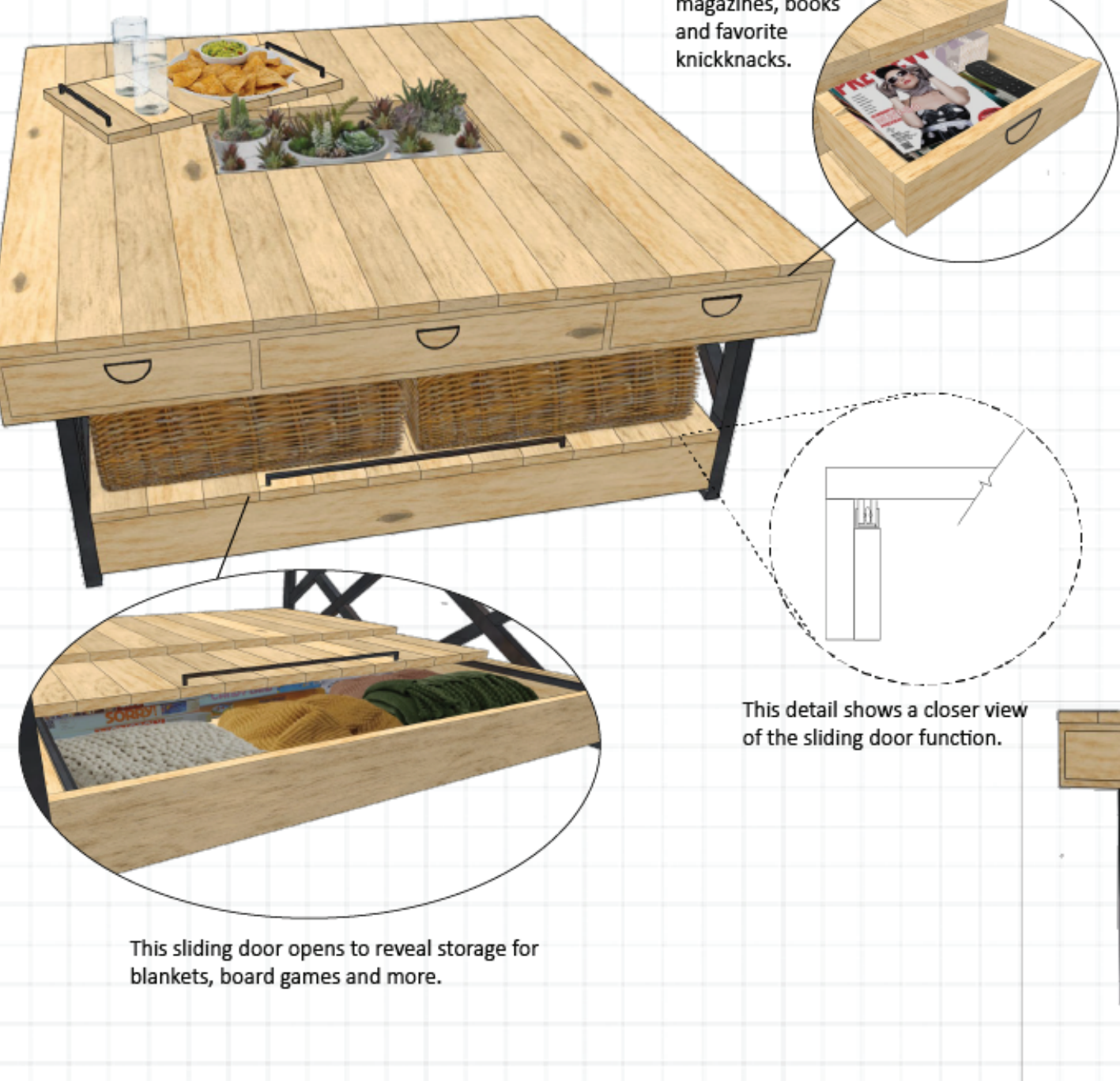

In this multi-purpose coffee table, I wanted to establish a sense of functionality while presenting a unique aesthetic. With storage located from top to bottom, this coffee table is great for blanket lovers, remote hoarders, and furniture collectors alike. The removable serving tray is not only great for party hosts but reveals an easy access storage compartment. You can also turn this compartment into a beautiful center piece! No matter how you use it, this piece is sure to add a newfound charm to any space.

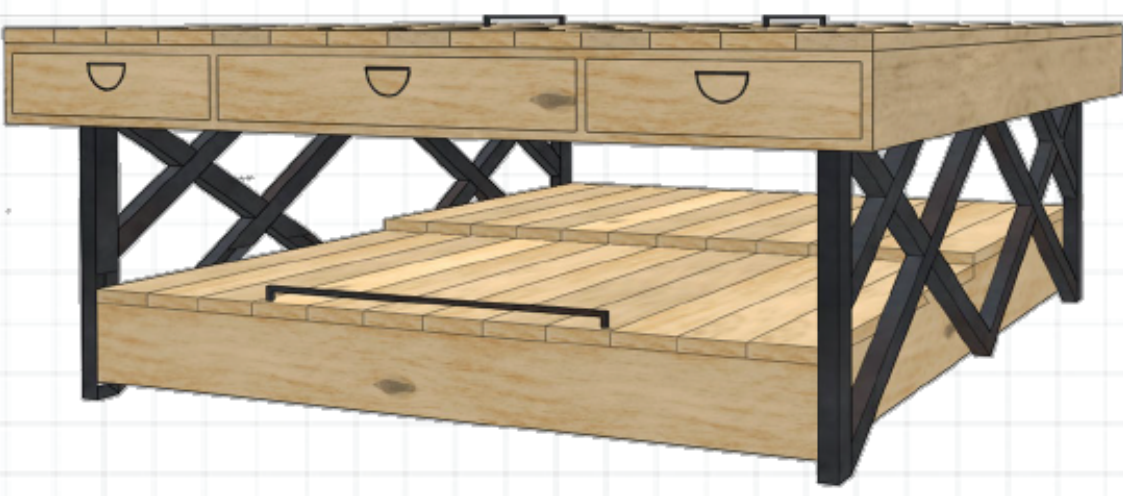

As a book lover myself, I wanted to create the ultimate display shelf. From its vertical spine shelf to its asymmetrical appearance, this bookshelf is sure to be a focal point of any space.

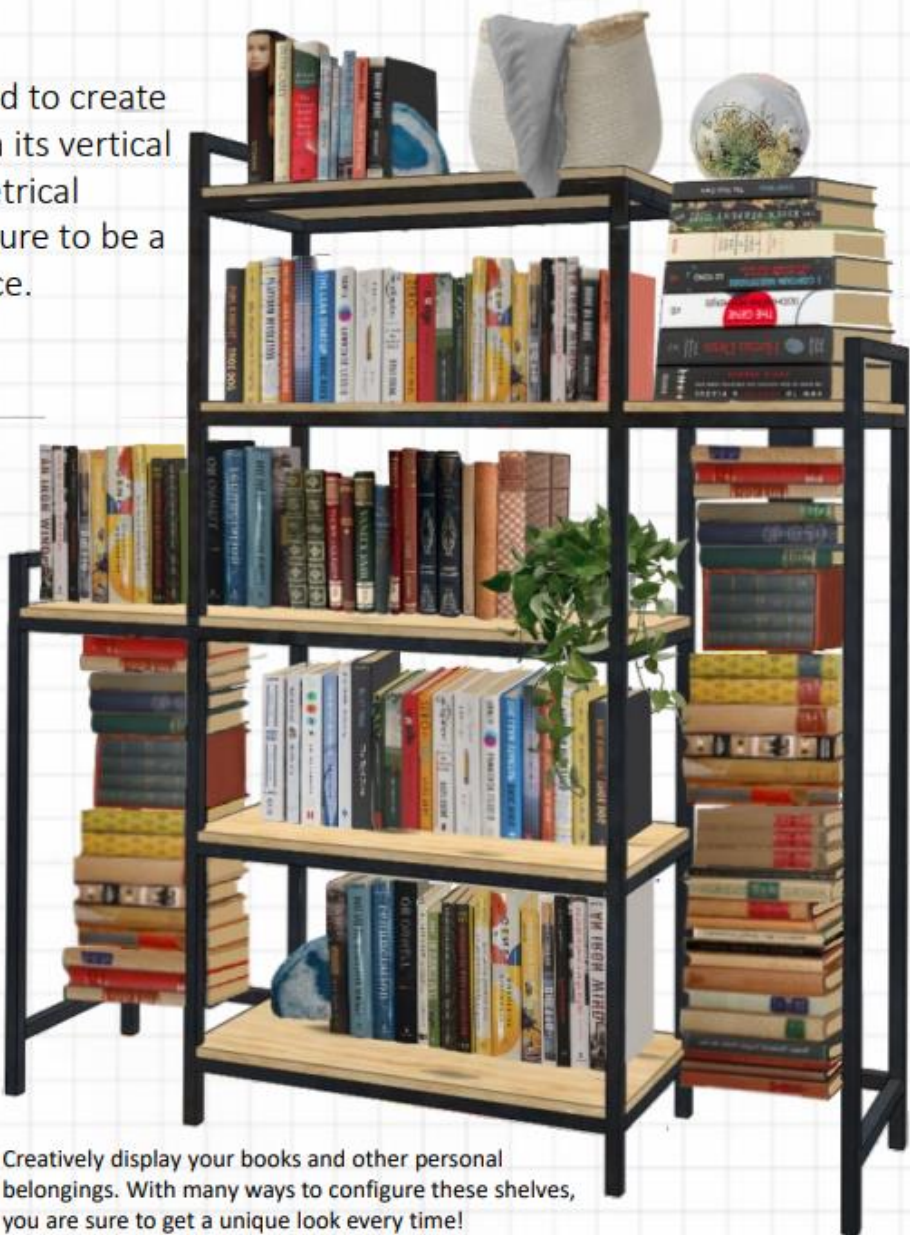

COFFEE TABLE
PURPOSEFUL DESIGN

Designed By: Cassandra Martin

This coffee table was designed for Purposeful Designs. Made up completely of walnut wood, and the legs being painted black. The inspiration for this piece was from designer and architect, Alvar Aalto. I created curvilinear accents within the pieces to give a feeling of the flexibility and freedom that he stood for. Simplicity is seen throughout with no hardware on the outside of the coffee table. The niche is provided to slide the door and reveal the storage within the coffee table. The slideable door adds levels and gives the piece of furniture purpose and flexiblity to change the aesthetic of the coffee table.



SIDE OF COFFEE TABLE

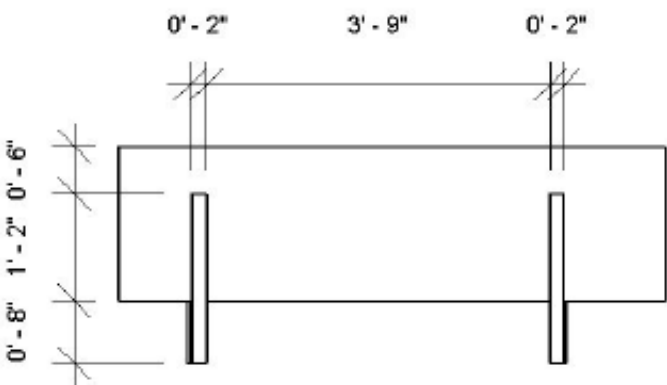

BOTTOM OF COFFEE TABLE

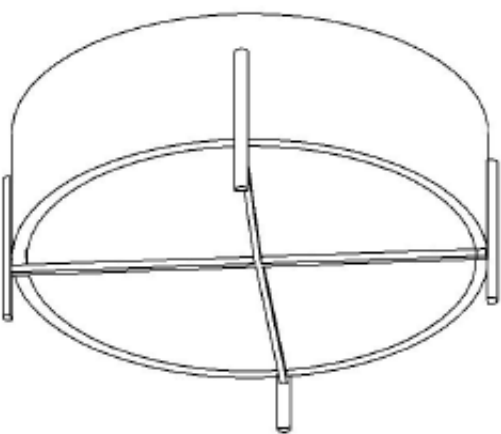

TOP OF COFFEE TABLE CLOSED

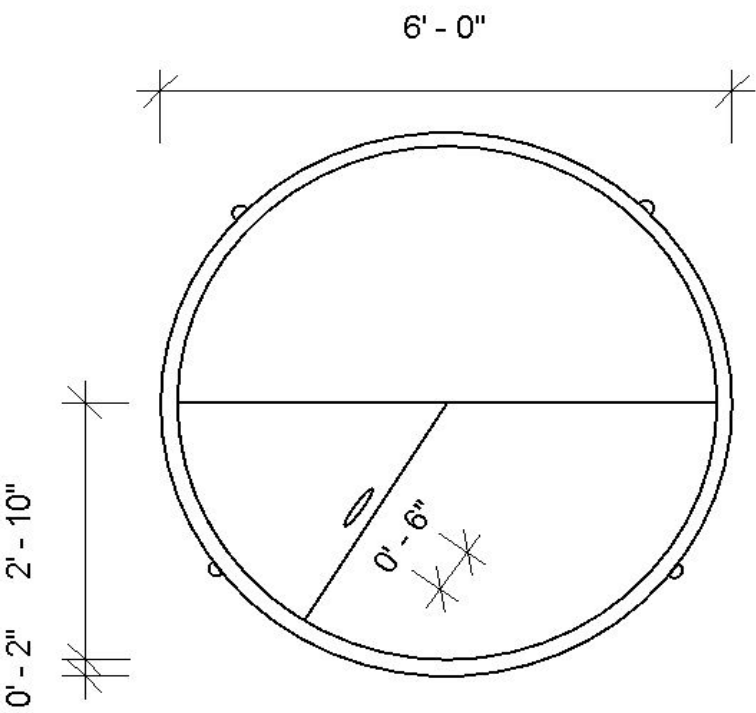

CURVED SLIDING
DOOR HARDWARE



WALNUT

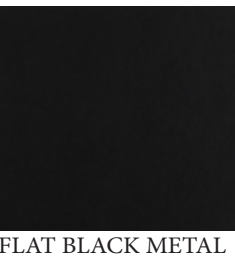

FLAT BLACK METAL

Floating Credenza

Created by: Brooke Willman



A multipurpose credenza that features two sliding drawers and one cabinet. The handles are seamlessly incorporated into the design by going the same direction as the open notches. The two black aluminum metal legs wrap around the stained ash base giving the illusion of a floating credenza.

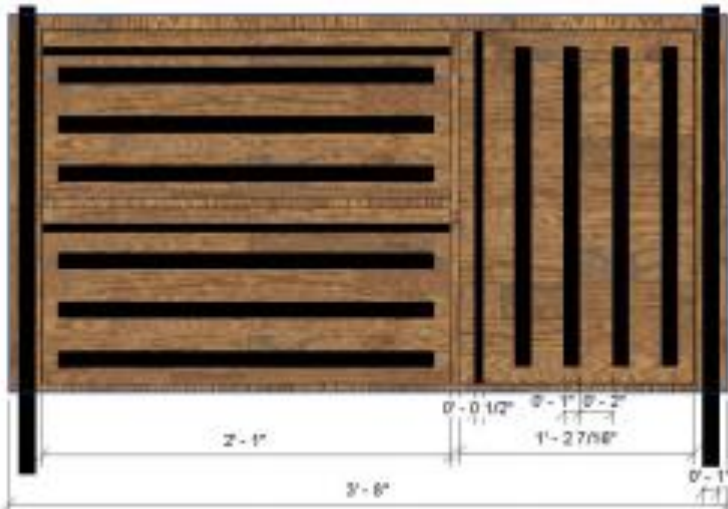

Front

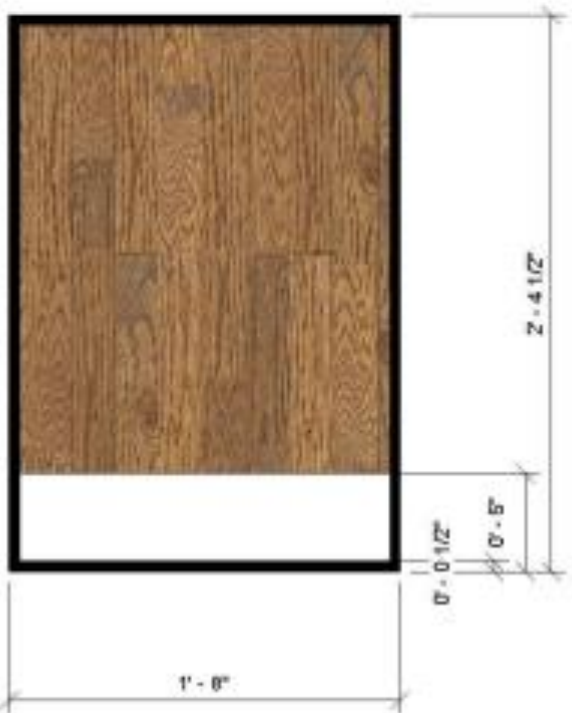

Side View



Cam Lock
Nut



Miter Butt
Joint